

IY5036

IYB30.8-BPKG/V2A/AS-514-TPS RT

Inductive sensors

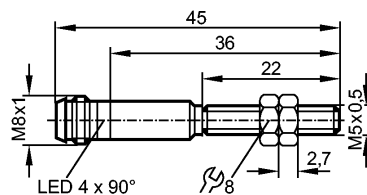

Made in Germany

Product characteristics

Inductive sensor

Metal thread M5 x 0.5

Connector

Sensing range 0.8 mm; [f] flush mountable

Electrical data

Electrical design	DC PNP
Operating voltage [V]	10...36 DC; "supply class 2" to cULus.
Current consumption [mA]	15 (24 V)
Protection class	III
Reverse polarity protection	yes

Outputs

Output function	normally open
Voltage drop [V]	< 2.5
Current rating [mA]	100
Short-circuit protection	pulsed
Overload protection	yes
Switching frequency [Hz]	2000

Range

Sensing range [mm]	0.8
Real sensing range (Sr) [mm]	0.8 ± 10 %
Operating distance [mm]	0...0.65

Accuracy / deviations

Correction factors	mild steel = 1 / stainless steel approx. 0.7 / brass approx. 0.5 / Al approx. 0.4 / Cu approx. 0.3
Hysteresis [% of Sr]	1...15
Switch-point drift [% of Sr]	-10...10

Environment

Ambient temperature [°C]	-25...70
Protection	IP 65

Tests / approvals

EMC	EN 60947-5-2 EN 55011: class B
MTTF [Years]	953

Mechanical data

Mounting	flush mountable
Housing materials	stainless steel (303S22); active face: POM (polyoxymethylene)
Weight [kg]	0.012

IY5036

IYB30.8-BPKG/V2A/AS-514-TPS RT

Inductive sensors

Displays / operating elements

Output status indication	LED	red (4 x 90°)
--------------------------	-----	---------------

Electrical connection

Connection	M8 connector
------------	--------------

Wiring

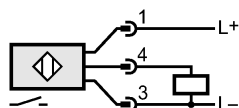

Accessories

Accessories (included)	2 lock nuts
------------------------	-------------

Remarks

Pack quantity	[piece]	1
---------------	---------	---